



## PASR 2025

# PARIS TO NORMANDY RIVER CRUISE ON BOARD THE AVALON TAPESTRY II

Sunday, October 19 – Tuesday, October 28, 2025

### YOUR RIVER CRUISE FROM PARIS TO NORMANDY INCLUDES

- Round trip air transportation to Paris, France from Philadelphia International Airport or Pittsburgh International Airport (including air taxes, government fees and fuel surcharges, which are subject to change at the discretion of the airline. Rates are **ESTIMATED** based on projected October 2025 air rates which are subject to change once October 2025 air rates are confirmed)
- One (1) night pre-cruise accommodations in Paris, France
- Round trip transfers in Paris (Airport – Hotel – Ship – Airport)
- Seven (7) night river cruise with river view stateroom on board Avalon Waterways' **AVALON TAPESTRY II** (including all port charges and cruise taxes)
- 20 meals ~ Seven (7) Breakfasts, Six (6) Lunches, Seven (7) Dinners on board your ship
- Complimentary sparkling wine with breakfast, regional wine, beer and soft drinks at lunch and dinner on board your ship
- Highlights and sightseeing in **Les Andelys, Vernon, Caudebec, Normandy, Rouen, Conflans and Paris** ~ as per the itinerary
- Included sightseeing with headsets and expert local guides
- Onboard local entertainment
- Complimentary Wi-Fi throughout the ship
- Portage for one (1) suitcase per person

### RATE PER PERSON\*

**CATEGORY D  
DELUXE STATEROOM  
\$5,778**

**CATEGORY B  
PANORAMA SUITE  
\$7,327**

**CATEGORY A  
PANORAMA SUITE  
\$7,427**

**CATEGORY P  
PANORAMA SUITE  
\$7,447**

\*Rate based on double occupancy. All rates and categories are subject to availability at time of booking.

### PASR GROUP BOOKING BONUS

- \$1,000 per person off the flyer rate
- Prepaid Shipboard Gratuities (for restaurant & stateroom services)

**OFFER EXPIRES APRIL 18, 2025**



# PARIS TO NORMANDY ITINERARY



## DAY 1 ~ OVERNIGHT FLIGHT TO PARIS, FRANCE

Depart the United States on your overnight flight to Paris, France.



## DAY 2 ~ OVERNIGHT HOTEL IN PARIS, FRANCE

Welcome to Paris, France! Upon arrival, you will be transferred to your hotel in Paris for the night. Today will be at your leisure. Get acquainted with **Paris**, the **City of Lights** today with some shopping or strolling the Parisian cityscape. Discover wonders of this romantic city, such as the world-renowned **Louvre Museum** or **Musée d'Orsay**. Perhaps go shopping in the **Faubourg Saint-Honoré** district or simply relax and spend the day like a local – by scoping out a local café for a café au lait, toasted baguette or croissant.

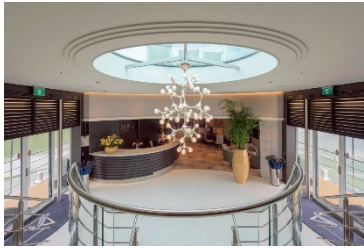

## DAY 3 ~ PARIS, FRANCE (EMBARKATION)

Today, check out of your hotel around Noon as your ship is ready for boarding. Your day is free to enjoy another day to explore the world's most romantic city before starting your cruise on the Seine. Enjoy taking in the signature sites of Paris, including the awe-inspiring **Arc de Triomphe** and iconic **Eiffel Tower**. All guests must be on board ship by 5:00 pm.

**EVENING/OVERNIGHT CRUISE TO VERNON**

**MEALS: DINNER**



## DAY 4 ~ LES ANDELYS ~ VERNON

### MONET'S MUSES, CASTLE COURTYARDS, AND CRÊPES DU JOUR

Enjoy breakfast onboard your beautiful ship.

Today, you can choose to explore Vernon's **Chateau des Tourelles** by foot with your Adventure Host.

**OR**

Take a guided tour of **Giverny**, home and inspiration of the master impressionist painter **Claude Monet**. Walk the grounds and see Monet's charming residence, and the flower and water gardens captured in his masterpieces.



**OR**



Enjoy a guided visit to **Bizy Castle**—called "Normandy's Versailles" for its magnificent courtyard, water garden, and stables.

Enjoy a traditional French luncheon of authentic French crêpes, followed by a Pastry Demonstration.

This afternoon, enjoy a beautiful cruise to the picturesque town of Les Andelys, located on one of the most beautiful and serene riverbends. Here you may take a guided walking tour of

Les Andelys – one of France's most picturesque spots on the Seine.

**OR**

Join a guided hike up to the castle ruins of **Château Gaillard**—historic home of King Richard the Lionheart.



**EVENING/OVERNIGHT CRUISE TO CAUDEBEC**

**MEALS: BREAKFAST, LUNCH, DINNER.**

## DAY 5 ~ CAUDEBEC

### ANCIENT ABBEYS ALONG THE SEINE

Enjoy breakfast on board the ship this morning.

Today, you might like to join your Avalon Adventure Host for a relaxing bike ride along the river.



OR

You may take a guided tour along the **Normandy Abbeys Route**—where more than 100 medieval Benedictine and Augustine abbeys and churches were built along the Seine.

This afternoon, you may choose a Guided Optional Excursion to the old seaside town of Honfleur.

Later enjoy live entertainment on board.



## OVERNIGHT DOCKING IN CAUDEBEC

MEALS: BREAKFAST, LUNCH, DINNER

## DAY 6 ~ CAUDEBEC ~ EXCURSION TO NORMANDY

### HEROIC BRAVERY ON NORMANDY BEACHES AND FRENCH FARMING TRADITIONS

Enjoy breakfast on board the ship this morning.



Today, join your Avalon Adventure Host on a guided tour of **Normandy's WWII** landing beaches, visit significant U.S. sites, including **Omaha Beach**, the **Pointe du Hoc** monument, and the **American Cemetery**.

OR

Take a full-day guided tour of the British and Canadian commemorative sites, including the British cemetery, **Pegasus Memorial**, the seaside town of **Arromanches**, the

**Juno Beach Center**, and the **Bény-sur-Mer Canadian War Cemetery**.



OR

Join "A Taste of Normandy" guided tour for an in-depth look at this rich agricultural region. See the famous **Bayeux Tapestry**, visit the beautiful village of **Beuvron en Auge** and taste Calvados at a local distillery.

Later, enjoy live entertainment on board your ship.

## EVENING CRUISE TO ROUEN

MEALS: BREAKFAST, LUNCH, DINNER

## DAY 7 ~ ROUEN

### THE CATHEDRAL OF OUR LADY AND A HEROINE FOR FRANCE

Enjoy breakfast on board the ship this morning.



Today, take a guided bike tour to discover and explore the most famous monuments and the lesser-known hidden gems of Rouen on two wheels.

OR

Take a guided walking tour of Rouen—site of Saint Joan of Arc's martyrdom—and see the medieval quarter with its 16th-century **Astronomical Clock**, and **Notre-Dame Cathedral**.

Enjoy onboard entertainment before setting sail this evening.

## EVENING/OVERNIGHT CRUISE TO CONFLANS

MEALS: BREAKFAST, LUNCH, DINNER

## DAY 8 ~ CONFLANS

### THE FOOTSTEPS OF VAN GOGH, BONAPARTE, AND LOUIS XIV

Enjoy breakfast on board the ship this morning.

Today, enjoy a relaxing bike ride along the Seine with your Avalon Adventure Host.

OR



Join a guided visit to **Auvers-sur-Oise**, home and resting place of **Vincent van Gogh**.

OR



Take a guided tour of the opulent **Château de Malmaison**—home of Napoléon Bonaparte and his wife Josephine. Perhaps, join a Guided Optional Excursion to the **Palace of Versailles**—home to a succession of French kings.

**EVENING CRUISE TO PARIS**

**MEALS: BREAKFAST, LUNCH, DINNER**

## DAY 9 ~ PARIS

### CAFÉS, CATHEDRALS, AND CANVASES IN THE CITY OF LIGHT

Enjoy breakfast on board the ship this morning.

Today, take a morning walk with your Avalon Adventure Host to see Paris at first light.



OR

Discover the ancient heart of Paris on a captivating guided walk featuring the **Palais-Royal**, **Louvre** pyramid, ancient sites on **Île de la Cité**, the Left Bank bustling Latin Quarter and more.

OR

Join a guided city tour, that shows you the iconic sites of Paris, such as the **Louvre Museum**, the **Arc de Triomphe**, the **Eiffel Tower**, **Opéra Garnier**, and the famous **Champs-Élysées**.



Following either tour, stroll through Paris on your own, or linger over wine in a literary café on the Left Bank.

**OVERNIGHT DOCKING IN PARIS**

**MEALS: BREAKFAST, LUNCH, DINNER**

## DAY 10 ~ PARIS (DISEMBARKATION)

### DEPART FOR THE UNITED STATES



Your vacation ends with breakfast on board your river vessel this morning. After disembarkation, you will be transferred by motorcoach to the airport in Paris for your return flight home to the U.S.

**MEALS: BREAKFAST**

# TAPESTRY II

## SKY DECK



## ROYAL DECK

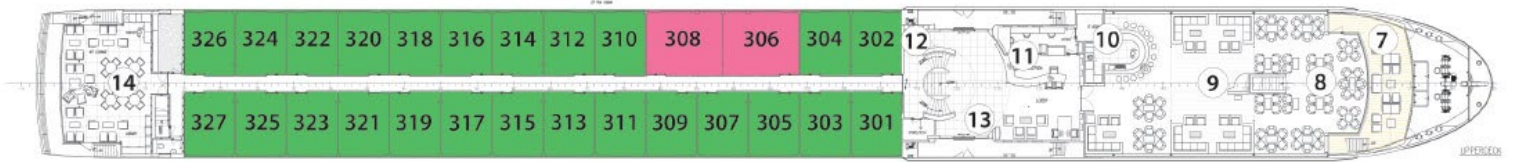

## SAPPHIRE DECK

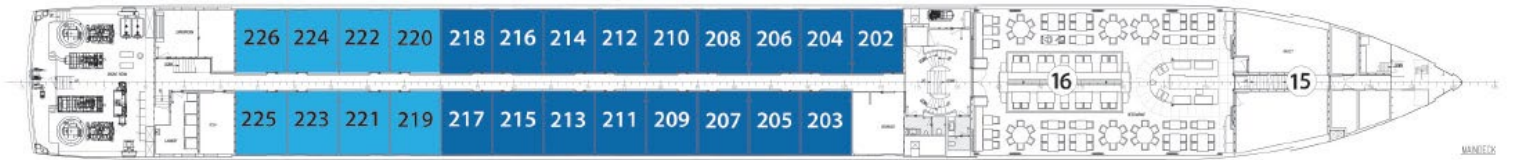

## INDIGO DECK

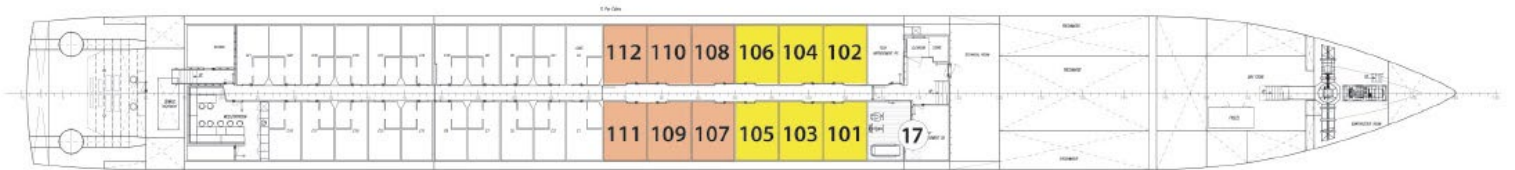

### DECK PLAN

- |   |                      |                   |
|---|----------------------|-------------------|
| 1 Sky Lounge                                    | 6 Deck Game Area     | 12 Elevator       |
| 2 Navigation Bridge                             | 7 Observation Lounge | 13 Lobby          |
| 3 Sky Grill                                     | 8 Panorama Bistro    | 14 Club Lounge    |
| 4 Whirlpool                                     | 9 Panorama Lounge    | 15 Galley         |
| 5 Premium Lounge<br>Chairs and Shade<br>Awnings | 10 Bar               | 16 Dining Room    |
|   | 11 Reception         | 17 Fitness Center |

### CATEGORIES

- Royal Suite Royal Deck | Royal Suites
- Cat. P Royal Deck | Panorama Suites
- Cat. A Sapphire Deck Forward | Panorama Suites
- Cat. B Sapphire Deck Aft | Panorama Suites
- Cat. D Indigo Deck Aft | Deluxe Staterooms
- Cat. E Indigo Deck Forward | Deluxe Staterooms

## GENERAL TERMS AND CONDITIONS

**RESERVATIONS:** A **NON REFUNDABLE** deposit of **\$350 PER PERSON** will be necessary in order to secure your tour river cruise package. The balance will be due to us by **WEDNESDAY, JULY 16, 2025**.

**PAYMENTS:** You may charge any portion or the entire amount to your Boscov's Charge, MasterCard or Visa. If paying by check, make it payable to **Boscov's Travel**.

**RESERVATIONS:** All categories are subject to availability at time of booking. Cruise taxes, port expenses and government fees are subject to change at any time without notice at the discretion of the cruise tour operator. All increases would be the responsibility of the tour package participant and must be paid in full prior to departure. Reservations paid in full at time of increase/change would not be exempt. Failure to pay these charges would result in denied boarding/travel.

**AVALON WATERWAYS PROMOTION: BOOK AND DEPOSIT AS SOON AS POSSIBLE AS SPACE IS LIMITED.** Receive **COMPLIMENTARY SHIPBOARD GRATUITIES** (for restaurant and stateroom services) as well as **\$1,000.00 OFF PER PERSON** from the flyer rates. Please note: this offer expires on Friday, April 18, 2025.

### **CANCELLATION:**

Your initial deposit, in the amount of **\$350.00 PER PERSON** is **NON-REFUNDABLE**.

For cancellations made between **Wednesday, July 16, 2025** and **Thursday, September 18, 2025**, **50% of the total river cruise package cost** will be assessed as a penalty, in addition to any non-recoverable costs, including air.

For cancellations made between **Friday, September 19, 2025** and **Saturday, October 18, 2025**, **80% of the total river cruise tour package cost** will be assessed as a penalty, in addition to any non-recoverable costs, including air.

For cancellations made on the day of departure (**Sunday, October 19, 2025**), **100% of the total river cruise tour package cost** will be assessed as a penalty. **NO REFUND WILL BE GIVEN.**

Travel Protections Plans are available to cover penalties for cancellations due to covered reasons.

**OPTIONAL TRAVEL PROTECTION PLAN:** Please refer to the Travel Protection Pricing Grid attached to this flyer.

**RESPONSIBILITIES:** Boscov's Travel, Inc. acts solely in the capacity of agent on behalf of its patrons, arranging transportation, accommodations, sightseeing, and other services, and, as such is not responsible for damage, loss, delay, injury, accidents, epidemics, pandemics, the spread of infectious diseases, quarantines or any other circumstances beyond our control or any act or default on the part of any company or person engaged in providing transportation, accommodations, sightseeing, or other services which are part of this tour.

**LIABILITIES:** Avalon Waterways expressly reserves the right to withdraw any tour or make any change in the tour, with or without notice that may become necessary. No carrier with whom transportation shall be arranged in connection with the tour shall have or incur any responsibility to any person taking the tour except its liability as a common carrier. Neither the airline, motorcoach company, Avalon Waterways nor Boscov's Travel shall be held liable for the loss of any property or valuables left onboard. Furthermore, anything left onboard shall be considered left at the owner's risk. No employee of the airline, motorcoach company, Avalon Waterways or Boscov's Travel may say anything to alter the liability of the foregoing for the airline, motorcoach company, Avalon Waterways or Boscov's Travel.

**TRAVEL DOCUMENTS:** All United States citizens must carry a **VALID U.S. PASSPORT BOOK** (not a passport card) with expiration date **AT LEAST SIX (6) MONTHS** beyond the last day of travel. If you don't have a passport book, contact your Boscov's Travel Advisor for information on how to apply for one.

**NOTE:** Due to airline/river cruise line security measures, your passport name **MUST** match your river cruise line/airline ticket name or you may be denied boarding.

10252024ija/mw



## Reservation Coupon

Send to: Boscov's Trave Camp Hill, Camp Hill Shopping Mall, 170 S. 32<sup>nd</sup> Street, Camp Hill, PA 17011. For more information contact your Boscov's Travel Advisor at 717.763.1100 or email [bostravcamphill@boscovs.com](mailto:bostravcamphill@boscovs.com)

OR: Boscov's Reading East Mall, 4500 Perkiomen Avenue, Reading, PA 19606. For more information, please contact a Boscov's Travel Advisor at 610-779-8640 or email [bostraveast@boscovs.com](mailto:bostraveast@boscovs.com).

OR: Boscov's Easton, 121 Palmer Park Mall, Easton, PA 18045. For more information, please contact a Boscov's Travel Advisor at 610-250-2772 or email [bostraveaston@boscovs.com](mailto:bostraveaston@boscovs.com).

OR: Boscov's Wilkes-Barre, 15 South Main Street, Wilkes-Barre, PA 18702. For more information, please contact a Boscov's Travel Advisor at 570-823-4141 or email [bostravwilkesbarre@boscovs.com](mailto:bostravwilkesbarre@boscovs.com).

OR: Boscov's Scranton, The Marketplace at Steamtown, 400 The Marketplace at Steamtown, Scranton, PA 18503. For more information, please contact a Boscov's Travel Advisor at 570-342-7860 or email [bostravscranton@boscovs.com](mailto:bostravscranton@boscovs.com).

OR: Boscov's Selinsgrove, 1 Susquehanna Valley Mall, Suite 2, Selinsgrove, PA 17870. For more information, please contact a Boscov's Travel Advisor at 570.374.0121 or email [bostravselinsgrove@boscovs.com](mailto:bostravselinsgrove@boscovs.com).

I would like to join PASR on the PARIS TO NORMANDY RIVER CRUISE (ROUNDTRIP PARIS), OCTOBER 19 – 28, 2025.

My FULL **NON REFUNDABLE** deposit of **\$350 per person** is enclosed for  # of person(s)

Cabin Category Selected:  Category D (Deluxe Suite)  Category B (Panorama Suite)

Category A (Panorama Suite)  Category P (Panorama Suite)

I/We wish to depart from:  Philadelphia International Airport  Pittsburgh International Airport

I wish to add the **OPTIONAL TRAVEL PROTECTION PLAN** – Please refer to the Travel Protection Pricing Grid attached to this flyer.

I **DECLINE TRAVEL PROTECTION PLAN**  Initials  Date

A VALID PASSPORT BOOK is required and is the responsibility of each passenger. Passport Books MUST be valid for up to SIX (6) MONTHS beyond the scheduled return travel date. Due to security requirements any name changes after documents are issued will incur a change fee. A clear and readable copy of passports are required.

**FULL LEGAL NAME(S) MUST BE LISTED EXACTLY AS IT APPEARS ON YOUR PASSPORT INCLUDING MIDDLE NAMES AND/OR INITIALS.**

#1 First Name  Middle Name  Last Name

Gender:  Male  Female Date of Birth  Passport Number  Date of Expiration

Street Address  City  State  Zip

Cell phone (  )  Email Address

Special Requests: (including but not limited to a CPAP machine, refrigerated medication, epi pen, mobility assistance devices, oxygen, dietary restrictions, special services, etc.):

#2 First Name  Middle Name  Last Name

Gender:  Male  Female Date of Birth  Passport Number  Date of Expiration

Street Address  City  State  Zip

Cell phone (  )  Email Address

Special Requests: (including but not limited to a CPAP machine, refrigerated medication, epi pen, mobility assistance devices, oxygen, dietary restrictions, special services, etc.):

Emergency Contact Name:  Phone: (  )  Relationship

**IMPORTANT: I have read and agree to the attached terms and conditions of the operator participant agreement and I authorize the use of my credit card if indicated as form of payment.**

Signature

Date

I wish to use my BOSCOV'S CHARGE #

EXP:

I wish to use my MASTERCARD/VISA #

EXP:  Sec Code:

I wish to pay by CHECK – please make check payable to **BOSCOV'S TRAVEL**

CHECK #





# BOSCOV'S TRAVEL PROTECTION PLAN

## SCHEDULE OF INSURANCE BENEFITS AND OTHER NON-INSURANCE SERVICES

Benefit	Maximum Benefit Amount
Trip Cancellation**	up to 100% of Trip Cost*
Trip Interruption**	up to 150% of Trip Cost*
Trip Delay - 6 hours	up to \$10 per day, to a maximum of \$750)
Single Supplement	Included
Missed Connection	up to \$300
Medical Evacuation and Repatriation of Remains Benefit	up to \$250,000
Political or Security Evacuation and Natural Disaster Evacuation	up to \$150,000
Baggage and Personal Effects	up to \$1,000 (\$250 per article)
Baggage Delay - 12 hours	up to \$500
Accident & Sickness Medical Expense	up to \$100,000
Dental Expense sublimit	up to \$750
Non-Insurance Travel Assistance Services	Included

## OPTIONAL UPGRADE BENEFITS - AVAILABLE FOR AN ADDITIONAL COST

Benefit	Maximum Benefit Amount
Cancel for Any Reason***	75% of Trip Cost*

Cost Of Trip	Rates	With CFAR***	Cost of Trip	Rates	With CFAR***
\$0-500	\$25.00	\$61.00	\$6,501-\$7,000	\$582.00	\$875.00
\$501-\$1,000	\$70.00	\$106.00	\$7,001-\$8,000	\$623.00	\$937.00
\$1,001-\$1,500	\$112.00	\$169.00	\$8,001-\$9,000	\$673.00	\$1,012.00
\$1,501-\$2,000	\$138.00	\$208.00	\$9,001-\$10,000	\$748.00	\$1,124.00
\$2,001-\$2,500	\$174.00	\$262.00	\$10,001-\$11,000	\$881.00	\$1,324.00
\$2,501-\$3,000	\$206.00	\$310.00	\$11,001-\$12,000	\$962.00	\$1,445.00
\$3,001-\$3,500	\$233.00	\$351.00	\$12,001-\$13,000	\$1,044.00	\$1,569.00
\$3,501-\$4,000	\$290.00	\$436.00	\$13,001-\$14,000	\$1,126.00	\$1,692.00
\$4,001-\$4,500	\$331.00	\$498.00	\$14,001-\$15,000	\$1,207.00	\$1,814.00
\$4,501-\$5,000	\$383.00	\$576.00	\$16,001-\$17,000	\$1,370.00	\$2,058.00
\$5,001-\$5,500	\$424.00	\$637.00	\$17,001-\$18,000	\$1,452.00	\$2,181.00
\$5,501-\$6,000	\$466.00	\$700.00	\$18,001-\$19,000	\$1,534.00	\$2,305.00
\$6,001-\$6,500	\$506.00	\$760.00	\$19,001-\$20,000	\$1,615.00	\$2,427.00

\*Up to the lesser of the Trip Cost paid or the limit of coverage on Your confirmation of coverage

\*\*\$500 Return air ticket cost only if \$0 Trip Cost displayed for Trip Cancellation on Your confirmation of coverage

\*\*\*Must be purchased within 14 days of the date your initial trip payment or deposit is received. Additional terms apply. Not available to residents of New York.

Trip Cancellation and Trip Interruption coverage only applies if trip is cancelled/interrupted by a covered peril.



# General Exclusions and Limitations for Insurance Benefits

Unless otherwise shown below, these exclusions apply to You, Your Traveling Companion, or Family Member scheduled and booked to travel with You.

**The following exclusion applies to the Trip Cancellation and Trip Interruption:** We will not pay for any loss or expense caused due to, arising or resulting from a Pre-Existing Medical Condition, as defined in the plan.

**The following exclusions apply to the Medical Expense benefits:**

1. routine physical examinations or routine dental care;
2. traveling for the purpose or intent of securing medical treatment or advice;
3. Alcohol or substance abuse or treatment for the same;
4. Normal pregnancy (except Complications of Pregnancy) or childbirth, or elective abortion;
5. a Mental, Nervous or Psychological Condition or Disorder unless Hospitalized or Partially Hospitalized while the certificate is in effect;
6. Your participation in Adventure or Extreme Activities, riding or driving in races, or participation in speed or endurance competition or events, except as a spectator;
7. Your participation in an organized athletic or sporting competition, contest, or stunt under contract in exchange for an agreed-upon salary or compensation. This does not include athletes participating in exchange for a scholarship or tuition;

**In addition to any applicable benefit-specific exclusion, the following general exclusions apply to all losses and all benefits.**

We will not pay for any loss or expense caused due to, arising or resulting from:

1. suicide, attempted suicide or any intentionally self-inflicted injury of You, a Traveling Companion, Family Member or Business Partner booked and scheduled to travel with You, while sane or insane;
2. being under the influence of drugs or narcotics, unless administered upon the advice of a Physician as prescribed;
3. activities, losses, or claims involving or resulting from possession, production, processing, sale, or use of marijuana, illegal drugs, alcohol or substances are excluded from coverage;
4. war or act of war, including invasion, acts of foreign enemies, hostilities between nations (whether declared or undeclared), or civil war;
5. the commission of or attempt to commit a felony or being engaged in an illegal occupation by You, a Traveling Companion, Family Member, or Business Partner;
6. directly or indirectly, the actual, alleged or threatened use, discharge, dispersal, seepage, migration, escape, release or exposure to any hazardous biological, chemical, nuclear radioactive weapon, device, material, gas, matter or contamination;
7. piloting or learning to pilot or acting as a member of the crew of any aircraft.
8. failure of any tour operator, Common Carrier, or other travel entity, person or agency to provide the bargained-for

Travel Arrangements for reasons other than Financial Insolvency or Financial Default. Important: there is no coverage for losses due to, arising or resulting from the Financial Insolvency or Financial Default of Your Travel Supplier or any entity that sold, solicited, negotiated, offered or disseminated this certificate to You or Your Traveling Companion.

**The plan also contains exclusions specific to Baggage and Personal Effects and Baggage Delay.**

## Pre-Existing Medical Condition Exclusion Waiver

The Pre-Existing Medical Condition Exclusion will be waived if you purchase the protection plan within 14 days of the date your initial trip payment or deposit is received and you are medically able and not disabled from travel at the time you purchase the plan, based on the assessment of a physician.

**To purchase this plan,  
please talk to your  
Bosco's Travel Advisor.**

This advertisement contains highlights of the plans developed by Travel Insured International, which include travel insurance coverages underwritten by United States Fire Insurance Company, Principal Office located in Morristown, New Jersey, under form series T7000 et al, T210 et al and TP-401 et al, and non-insurance Travel Assistance Services provided by C&F Services. The terms of insurance coverages in the plans may vary by jurisdiction and not all insurance coverages are available in all jurisdictions. **Insurance coverages in these plans are subject to terms, limitations and exclusions including an exclusion for pre-existing medical conditions.** In most states, your travel retailer is not a licensed insurance producer/agent, and is not qualified or authorized to answer technical questions about the terms, benefits, exclusions and conditions of the insurance offered or to evaluate the adequacy of your existing insurance coverage. Your travel retailer may be compensated for the purchase of a plan and may provide general information about the plans offered, including a description of the coverage and price. The purchase of travel insurance is not required in order to purchase any other product or service from your travel retailer.